

OFFERING YOU THE MOST IN STANDING SEAM ROOF TECHNOLOGY

07610/STA
BuyLine 4834



Star Building Systems



STARSHIELD

STARSHIELD: WEATHERTIGHT PROTECTION DESIGNED TO LAST.

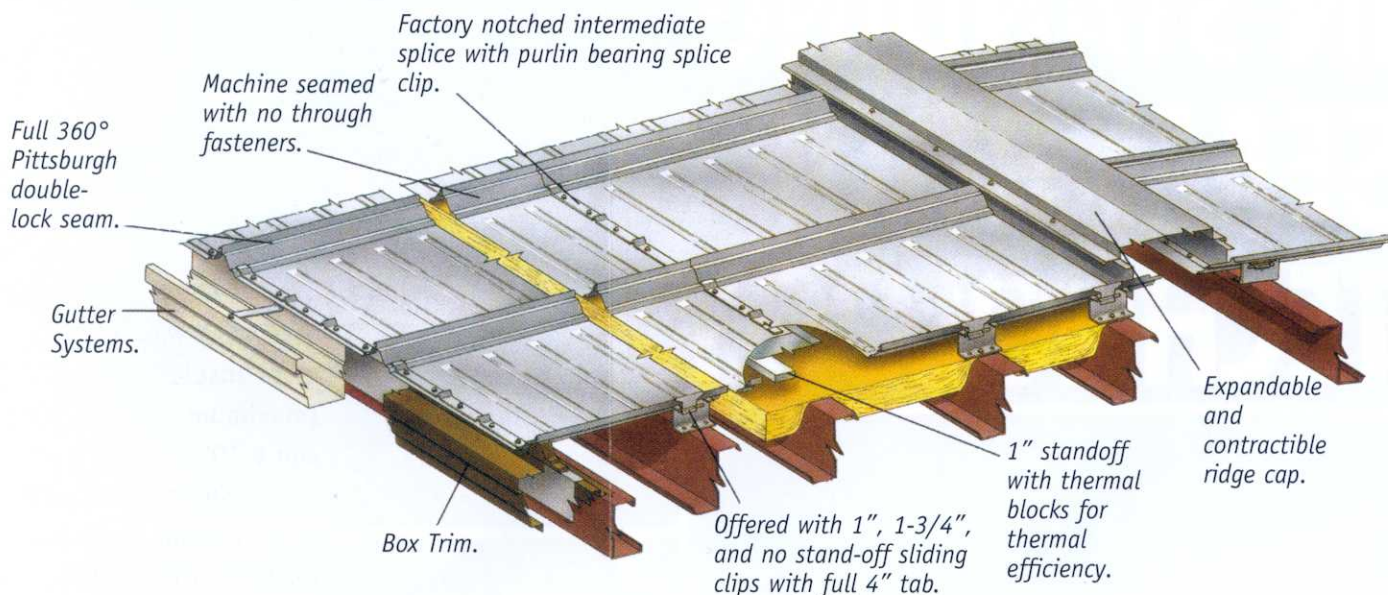

StarShield Standing Seam Roof System gives building owners what they deserve, lasting protection against the elements smartly designed to save you money.

Weather-tightness is a crucial component of any roof system, and StarShield, by design, has those qualities to ensure a safe, dry environment. Machine seamed on a proven 360° Pittsburgh double-lock configuration, our roof is sealed on the outside, protecting the inside from the stress of elements.

A two-part sliding clip is now available in four clip types. These clips have no through fasteners, permitting the roof to move independently of the roof structure, a durable and proven feature that survives the constant thermal stresses caused by expansion and contraction.

StarShield can rest on the structure, or can stand-off either 1" or 1-3/4" for thicker insulation. For longer panel runs up to 240 feet each side of the ridge, there is an additional clip that has even greater expansion contraction ability.

And, StarShield carries Underwriters Laboratories' Class 90 for wind resistance and FM 1-60, 90, and 120 approvals.

It's a proven system that withstands hurricane winds, pounding rains, and extreme temperatures on both ends of the weather scale.

Energy-efficient performance, that's StarShield by design. StarShield will maintain a consistent, quality controlled environment when used in combination with fiber glass insulation or rigid foam insulation. StarShield's stand-off design will not compress insulation completely, therefore making it much more efficient.

Add strength to StarShield's design with 24- and 22-gauge Aluminum-Zinc alloy-coated steel backed with a 20-year warranty. And, you can specify full 70% Kynar® 500, Star's Ultra Premium-20 color finish system. These factors give our roof the advantage.

Whether it's a new roof or a retrofit project, StarShield provides the answers. So give your building the protection it deserves. StarShield is the solution.

COMPOSITE OPTION

07610/STA
BuyLine 4834

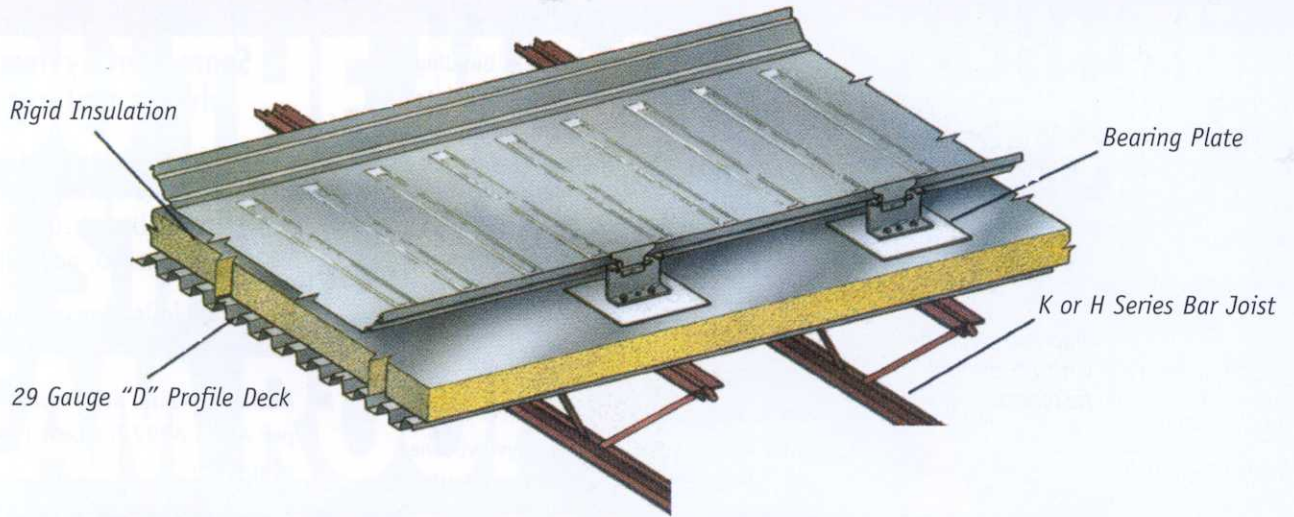

COMPOSITE OPTION (CSS)
StarShield roof with
Rigid Insulation
(maximum 4" thickness)
and a "D" profile liner
panel. Suitable for joist
construction. Qualified
for UL90 wind uplift.

RETROFIT SOLUTIONS

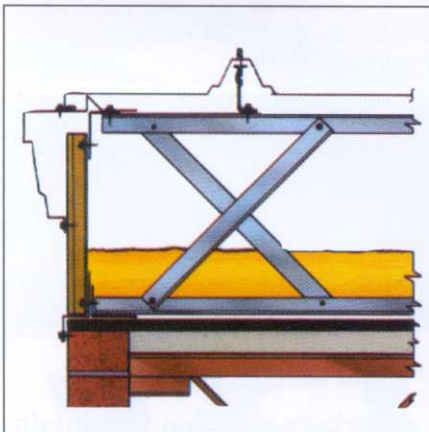

StarShield to replace or retrofit existing roof.

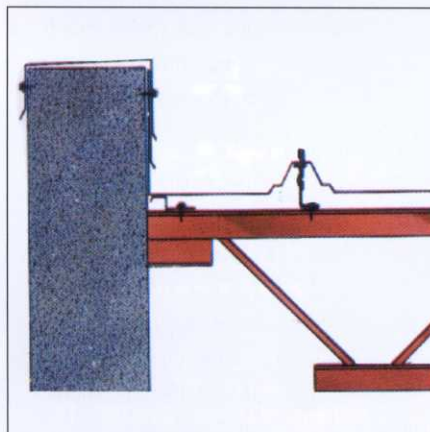

StarShield on bar joist with masonry walls and existing flat roof.

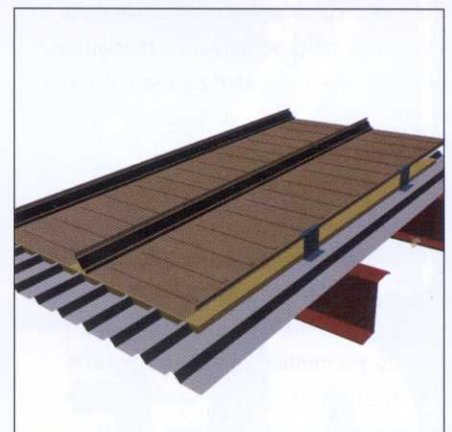

StarShield on purlins over existing metal roof.

GENERAL INFORMATION

General

The roof system will consist of metal panels joined together by an interlocking clip. Integral components such as start and finish panels, ridge cover, perimeter trim, gutter and flashings will be furnished as required.

Panel Description

All StarShield panels will be precision roll formed to 24" wide coverage. Finished panels will have the edges formed into a 2" high box rib plus a 7/8" high seam. The panel flat will be embossed with cross ribs at 6" on center.

Panel Design

Design shall be in accordance with AISI specifications for the design of light gauge, cold-formed steel structural members.

The panel seam will be designed to positively interlock the panel and clips. The seam will contain factory-installed sealant.

The panel clips will be of two-piece sliding design to accommodate expansion movement and will support the panel above the structural system. The various clips provide 1", 1-3/4", or no stand-off from the structure.

Panel end splices will be designed with a 3" overlap and heavy gauge clamping plates to provide panel continuity. The splices will be independent of the structural system to accommodate expansion movement.

The ridge cover and flashings will be of an expansion joint design to accommodate thermal movement of the panel.

After the panels are installed, the seam will be closed to a double-lock 360 seam, with a motorized seamer.

Panel Material and Finish:

The roof will be covered with StarShield panels of roll formed 22 or 24-gauge, 50,000 psi minimum yield steel (ASTM A653) Structural Quality Grade 50 with Aluminum-Zinc alloy coating (ASTM Specification A792).

Tested Fire Rated Roof System

StarShield can be used in Metal Building Manufacturer's Association (MBMA) tested roof systems for 1 and 1-1/2 hour fire rated systems (see MBMA tech bulletin #17.)

Warranties

All roof panels shall be warranted for a period of 1 year for defects in materials and workmanship.

StarShield can be coated with Starguard 950 Siliconized Polyester Finish or Star's Ultra Premium Kynar® 500 polyvinylidene fluoride resin finish, both with long life warranties.

All roof panels are available with warranties of 20 years against perforation according to manufacturer's standard warranty.

Weathertightness warranties are available.





Star Building Systems are erected by independent building contractors, not agents of Star. All Star claims as to the ultimate performance of its products are contingent upon proper erection techniques as employed by the erecting contractor. These techniques must be in accordance with Star's suggested erection procedures. Star is not liable for damages incurred through improper erection procedures. Descriptions and specifications contained herein were in effect at the time this publication was approved for printing. Star reserves the right to discontinue products at any time or change specifications and/or designs without notice and without incurring obligation.

StarShield® Standing Seam Roof Systems always feature:

- One of the most tested standing seam roofs available, including ASTM E1592, U1580, CEGS, ASTM E330, FM 1-60, 90, and 120.
- 360° double-lock seam to assure weathertightness.
- Aluminum-Zinc alloy-coated steel per ASTM A792 for best corrosion protection.
- Cross ribs at 6" on centers for noise and oil can control and added stiffness.
- Mechanically sliding clip provides stress-free floating roof planes up to 120' or 240'.
- Seal tight endlap design to keep moisture out.



See Sweet's CD for CSI Format 3-Part Specification.

SEE US IN     



8600 S. I-35, P.O. Box 94910
Oklahoma City, OK 73143
1-800-654-3921 Fax: 405-636-2419

Visit us on the internet:
www.starbuildings.com
or e-mail us at:
Holly.Chambers@starbuildings.net

For a Free StarShield Product Digest with more information and design/specification criteria concerning StarShield Standing Seam Roof Systems, call 1-800-654-3921.